

# SUBMITTAL: STC-RATED ACCESS PANEL - STC™ SERIES

JL Industries Introduces the First STC-Rated Access Panel with an STC 47 Rating. Meet Noise Containment and Sound Transmission Blocking Requirements for Walls with the US Patent-Pending STC Panel

**Installation:** Walls only. Use sound-blocking sealant.

**Construction:** 16 gauge CRS 1" Wide Frame, and Door is 20 gauge CRS

**Finish:** White powder coat paint.

**Hardware:** Heavy Duty, Continuous Hinge

**Latch/Lock:** Black, Non-locking Compression Paddle Latch, 2 for Heights Greater than 30". (F3)

**Gasketing:** Heavy Duty EPDM Rubber

**Insulation:** Proprietary Sound-Blocking Assembly

**STC Rating:** 47 When Installed as Directed in STC-rated Wall.

**Sizes:** Minimum 12" x 12", Maximum 24" x 36"

**Labeling:** Intertek Warnock Hersey Listing

**Patent Pending:** US5171079

Please Note - Color Codes and Lock Option Codes have Changed.

### Optional Features At Additional Cost

- Locking Flush Black Paddle Latch (F4) see pg 2
  - Locking Paddle Latch Chrome-plated (F6) see pg 2
  - Non Locking Paddle Latch Chrome-plated (F5) see pg 2
  - Stainless Steel - 16 ga Frame, 20 ga Door
  - Galvanneal Steel - 16 ga Frame, 20 ga Door
  - Other Powder Coat Paint Colors. Indicate Color Code Here: \_\_\_\_\_
  - Other Sizes up to 24" x 36" - Opening Size: \_\_\_\_\_" W x \_\_\_\_\_" H
- Available in 1/4" Door Size Increments. Wall Opening is + 3/8"

### TESTED IN ACCORDANCE WITH:

**ASTM E90-09**  
Sound Transmission Loss of Building Partitions



### CLASSIFIED IN ACCORDANCE WITH:

**ASTM E413-10** Classification for Rating Sound Insulation of Partitions or Floors

**ASTM E1332-10a** Standard Classification for Rating Outdoor-Indoor Sound Attenuation



STC-1212F3W Above in White



Model Size is Door Size				
Qty	Model & Size (A) W X H (inches)	Wall Opening Dimension (C)	Approx. Weight	Latch (es)
	STC-1212	12 3/8 x 12 3/8	14	1
	STC-1414	14 3/8 x 14 3/8	18	1
	STC-1616	16 3/8 x 16 3/8	23	1
	STC-1818	18 3/8 x 18 3/8	29	1
	STC-2030	20 3/8 x 30 3/8	53	2
	STC-2222	22 3/8 x 22 3/8	40	1
	STC-2230	22 3/8 x 30 3/8	53	2
	STC-2236	22 3/8 x 36 3/8	55	2
	STC-2424	24 3/8 x 24 3/8	46	1
	STC-2430	24 3/8 x 30 3/8	54	2
	STC-2436	24 3/8 x 36 3/8	60	2
Other Sizes up to 24" x 36" in 1/4" Increments Door Size Available				



STC-2436F3G in Gray

	Distributor:	Quantity:
	Contractor:	Approved By:
	Model #:	Architect:
	Project:	Date:

# SUBMITTAL: STC-RATED ACCESS PANEL - STC SERIES

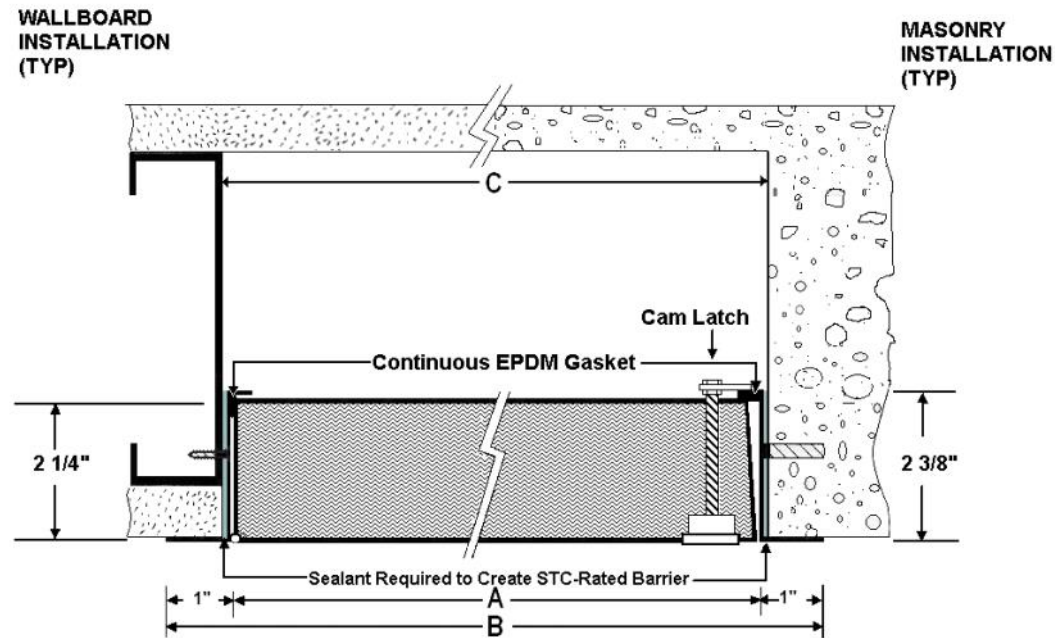

THE STC ACCESS PANEL CAN BE INSTALLED IN A WIDE RANGE OF STC-RATED WALLS  
THE DRAWING ABOVE IS AN EXAMPLE ONLY



Gasketing: Heavy Duty EPDM Rubber

Optional Colors at Additional Cost - Samples Available			
G-Gray	R-Red	BK-Black/FB Flat	SI - Silver
S-Sand	AB-AMS Beige	SB-SC Flat Beige	B-Bronze

Order Format: STC- \_\_\_\_\_ Width \_\_\_\_\_ Height \_\_\_\_\_ Lock Code \_\_\_\_\_ Color Code \_\_\_\_\_ STC-2436F3W

Locks: F3 (non locking black latch)  
F4 (locking black latch)  
F5 (non locking zinc latch)  
F6 (locking zinc latch)

Model # Stainless: STCS  
Model # Galvanneal: STCG