



SUBMITTAL/TECHNICAL DATA SHEET

Door is fabricated from 20 gauge, galvanized steel with a white prime coat finish. Door panel is provided with 2" of insulation in a sandwich type construction.

Frame is fabricated from 16 gauge, galvanized steel with a white prime coat finish and provided with masonry anchors and bolt holes.

Hinge is fully concealed and mounted on the long side of the rectangular door panel.

Exterior latch is a dual purpose lock that features a knurled knob and key operation. Both are provided at time of shipping.

Interior latch release slide is included enabling door to be opened from the inside.

SKU: **FRC**

FIRE RATED CEILING ACCESS DOORS



GUIDE SPECIFICATION

Fire Rated Ceiling Access Doors (specify model number and options). Access door frame shall be fabricated from 16 gauge galvanized steel with a white prime coat finish and provided with masonry anchors and bolt holes. Access door panel shall be fabricated from 20 gauge, galvanized steel with a white prime coat finish. Door shall be filled with 2" thick, fire rated insulation, and be welded pan type. Access door shall have automatic closer, be self-latching and contain interior latch release. Exterior latching shall be recessed and universal self-latching bolt, operated by either a knurled knob or flush key. Finish shall be a white prime coat suitable for painting.

Underwriters Laboratories classification shall be: Classified access frame and fire door assembly 1-1/2 hours, "B" Label. Meets ANSI-UL 10B standard. Finish shall be a white prime coat suitable for painting.

MODEL NUMBER AND OPTIONS SELECTION

BASE MODEL NUMBER

☐ -FRC Fire Rated Ceiling Access Door

SUFFIX OPTIONS

- ☐ -GB Galvanized Drywall Bead
- ☐ -MLP Mortise Cylinder Lock (Prep)
- ☐ -SS Stainless Steel Construction (Type 304 No. 4 Satin Finish)

For a complete list of options visit
www.AccessDoorsAndPanels.com

DIMENSIONS AND APPEARANCE

>> CLICK TO VIEW ADDITIONAL DETAILS AND PRICING <<

STANDARD SIZES:

NOMINAL DOOR SIZE (W x H)	CEILING OPENING	WALL OPENING	LOCK QTY	WEIGHT LBS
FRC 8" x 8"	9-5/8" x 9-5/8"	8-3/8" x 8-3/8"	1	11.0 LBS.
FRC 10" x 10"	11-5/8" x 11-5/8"	10-3/8" x 10-3/8"	1	12.0 LBS.
FRC 12" x 12"	13-5/8" x 13-5/8"	12-3/8" x 12-3/8"	1	15.0 LBS.
FRC 14" x 14"	15-5/8" x 15-5/8"	14-3/8" x 14-3/8"	1	17.0 LBS.
FRC 16" x 16"	17-5/8" x 17-5/8"	16-3/8" x 16-3/8"	1	18.0 LBS.
FRC 18" x 18"	19-5/8" x 19-5/8"	18-3/8" x 18-3/8"	1	20.0 LBS.
FRC 18" x 24"	19-5/8" x 25-5/8"	18-3/8" x 24-3/8"	1	26.0 LBS.
FRC 20" x 20"	21-5/8" x 21-5/8"	20-3/8" x 20-3/8"	1	24.0 LBS.
FRC 22" x 30"	23-5/8" x 31-5/8"	22-3/8" x 30-3/8"	2	32.0 LBS.
FRC 22" x 36"	23-5/8" x 37-5/8"	22-3/8" x 36-3/8"	2	40.0 LBS.
FRC 24" x 24"	25-5/8" x 25-5/8"	24-3/8" x 24-3/8"	1	28.0 LBS.
FRC 24" x 36"	25-5/8" x 37-5/8"	24-3/8" x 36-3/8"	2	40.0 LBS.

NOTE:

On sizes 16" x 16" and larger, an extra spring is supplied with the door and must be attached from back of door pan to framing, or floor above, in such a manner to ensure that door is self closing.

1. LATCH SPRING
2. HINGE BRACKET
3. HINGE PIN
4. DOOR
5. FRAME

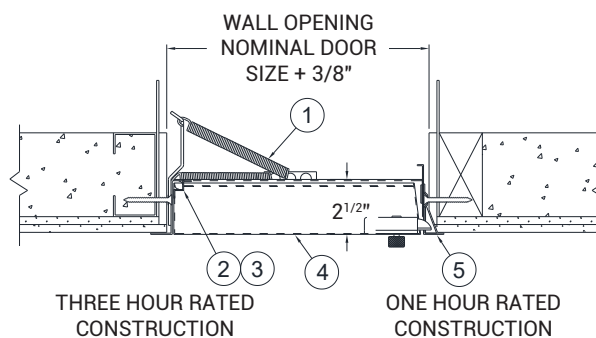

SIDE VIEW

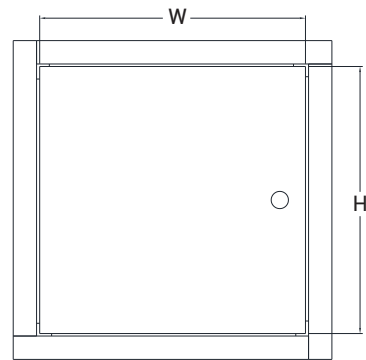

FRONT VIEW

PROJECT DATA

Custom Sizes Available - Fast!

Scan or Click



To view Pricing and
Additional Product Info.

PROJECT NAME :	QTY	W	H	OPTIONS
ARCHITECT :				
DEALER :				
CONTRACTOR :				
LOCATION :	SPECIAL INSTRUCTIONS :			
DATE :	SUBMITTAL APPROVAL : (signature or stamp)			
TAGGING INSTRUCTIONS :				



TELEPHONE:
1-888-457-1275
FAX:
1-888-626-2907



PO BOX 66738 #76520,
SAINT LOUIS, MO
63166-6738
USA



WEBSITE:
www.AccessDoorsAndPanels.com
E-MAIL:
info@AccessDoorsAndPanels.com