



JL INDUSTRIES

SUBMITTAL/TECHNICAL DATA SHEET

DESCRIPTIONS

The largest three hour wall and ceiling door available on the market, offering architects and engineers unprecedented flexibility in designing. Double leaf reduces the swing radius and clears objects which interfere with the opening of the door. Tested and listed by Intertek Warnock Hersey for a three hour fire rating.

SPECIFICATION

MATERIALS: Satin finish galvanized steel or 304 stainless steel

FRAME: 16 ga., up to and including 30" x 48". Larger sizes are 14 ga. Removable center mullion. Frame Depth 3 1/4" (83mm).

FLANGE: 7/8" (22 mm) up to and including 36" x 36". Larger sizes are 1-1/4" (32mm).

DOOR PANEL: 18 ga. panel with 22 ga liner.

INSULATION: The door panel contains 2 1/2" of high temperature insulation material.

FINISHES: Rust-inhibitive off-white prime coat or # 4 polished stainless steel finish on exterior surface.

HINGES: Concealed continuous rod hinge. 48" or longer in wall position will be a continuous piano hinge. Stainless models have a stainless steel continuous piano hinge. Hinge is the (H) dimension.

PANEL CLOSER: The automatic panel closer will close & latch the door from an open position of approximately 90° as required by NFPA 80.

LATCH: The standard factory installed latch is a flush mount 1/4" Allen key. All fire-rated locks are self-latching and include an interior latch release mechanism allowing the doors to be opened from the inside.

SIZES:

Minimum size 30" x 12"(W x H)
Maximum size for walls is 48" x 60"
for Ceilings is 60" x 48"

SKU: **FD3D**

3HR FIRE-RATED ACCESS PANEL DOUBLE DOOR



DIMENSIONS AND APPEARANCE

>> CLICK TO VIEW ADDITIONAL DETAILS AND PRICING <<

STANDARD SIZES:

Rough Opening Size W x H H = Hinge Side		No. of Latches/ Locks	Weight	
Inches	Metric(mm)		Kgs	Lbs.
36 x 48	914 x 1219	2	41.28	91
40 x 40	1016 x 1016	2	38.56	85
40 x 48	1016 x 1219	4	44.91	99
48 x 36	1219 x 914	2	41.28	91
48 x 40	1219 x 1016	4	44.91	99
48 x 48	1219 x 1219	4	52.16	115
60 x 24	1524 x 610	2	37.65	83
60 x 30	1524 x 762	2	44.91	99
60 x 36	1524 x 914	4	51.71	114
60 x 40	1524 x 1016	4	56.25	124
60 x 48	1524 x 1219	4	65.32	144
ADDITIONAL SIZES WALL ONLY BELOW				
24 x 60	610 x 1524	4	37.65	83
36 x 60	914 x 1524	4	51.71	114
48 x 60	1218 x 1524	4	65.32	144

Net Opening = Width minus 8-1/2" (216mm),
Height minus 1-1/2" (39 mm)

For detailed specifications see submittal sheet

LATCH AND LOCK OPTIONS

Standard 1/4" Allen Key (A)	Optional Knurled Knob (KK)	Optional Mortise Lock (MPI)

FIRE-RATING INFORMATION

Intertek Warnock Hersey Listed and Labeled:
2 Hour Fire Rating for vertical and horizontal installation.



Temp Rise Max: 43° C/77° F at 30 Min
149° C/268° F at 60 Min.

Testing Standards:

Vertical: NFPA 252, UL 10B, CAN/ULC S10 4
Horizontal: UBC 43-7, CAN/ULC S112

Other sizes available upon request for all Models.
Second dimension given is the hinge side (shown in Blue)
unless otherwise specified

THIS MODEL AVAILABLE IN 2 HOUR
RATING ALSO—SEE SEPARATE
SUBMITTAL

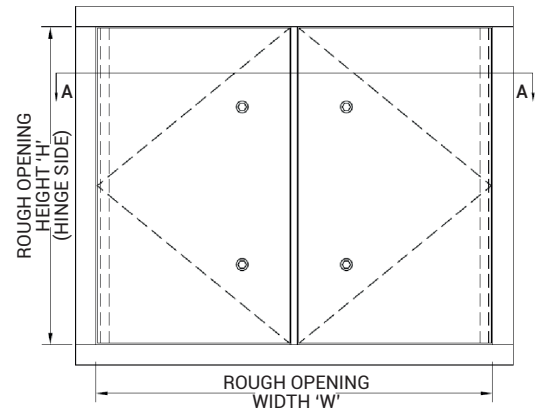

For a complete list of options visit
www.AccessDoorsAndPanels.com

PROJECT DATA

Custom Sizes Available - Fast!

Scan or Click



To view Pricing and
Additional Product Info.

PROJECT NAME :	QTY	W	H	OPTIONS
ARCHITECT :				
DEALER :				
CONTRACTOR :				
LOCATION :	SPECIAL INSTRUCTIONS :			
DATE :	SUBMITTAL APPROVAL : (signature or stamp)			
TAGGING INSTRUCTIONS :				

TELEPHONE:
1-888-457-1275
FAX:
1-888-626-2907



PO BOX 66738 #76520,
SAINT LOUIS, MO
63166-6738
USA



WEBSITE:
www.AccessDoorsAndPanels.com
E-MAIL:
info@AccessDoorsAndPanels.com



FD3D 3 HOUR FIRE-RATED ACCESS PANEL - DOUBLE DOOR

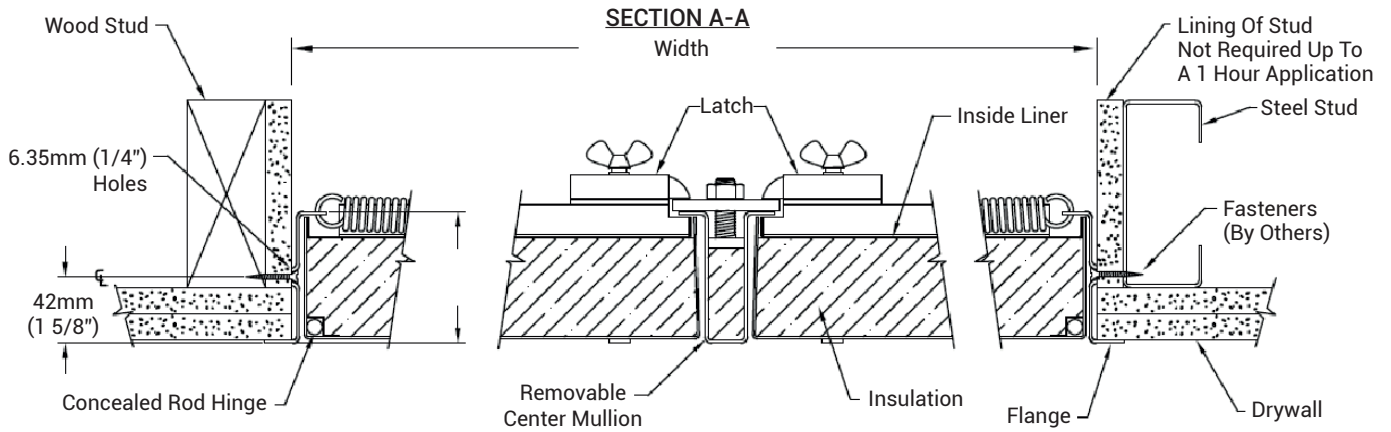

SELECT LATCH AND LOCKS BELOW OR ON PAGE 3 :

FOUR LATCHES

TWO LATCHES

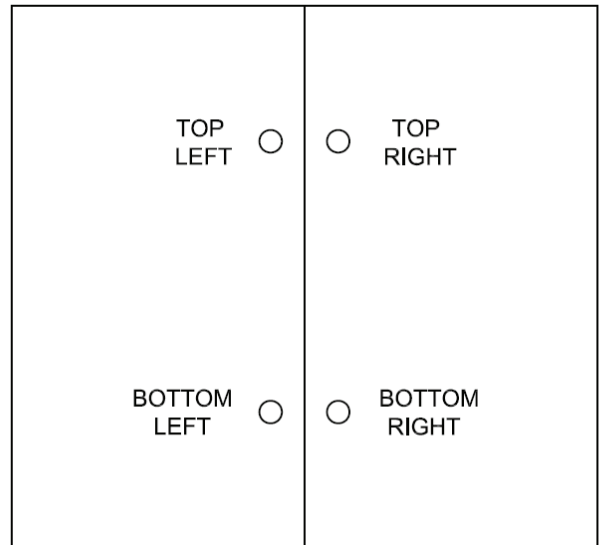
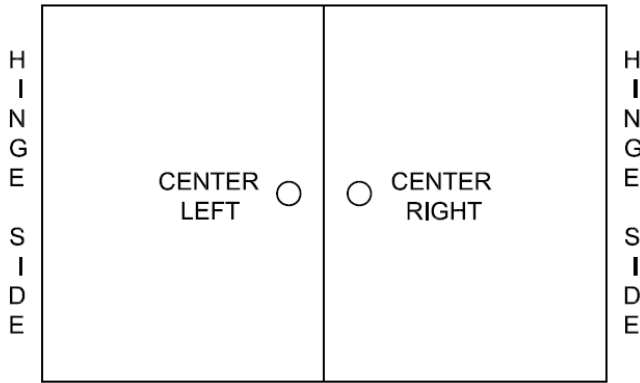

- Center Left**
- Latch and Lock Option For Centered Latches**
- 1/4" Allen Key
 - Raised Knurled Knob
 - 1-1/8" Mortise Prep*
 - 1-1/8" Mortise Prep with Cylinder*
- Center Right**

Concealed Operator One Side Only - Select Operator for Other Side from Above Options

* Lock Option at Additional Cost

- Top Left**
- Latch and Lock Options For 4 Latches**
- 1/4" Allen Key
 - Raised Knurled Knob
 - 1-1/8" Mortise Prep*
 - 1-1/8" Mortise Prep with Cylinder*
- Top Right**
- Bottom Left**
- 1/4" Allen Key
 - Raised Knurled Knob
 - 1-1/8" Mortise Prep*
 - 1-1/8" Mortise Prep with Cylinder*
- Bottom Right**

Concealed Operator One Side Only -Select Operator for Other Side from Above Options
Example: If Concealed Operator is on Left Door, Select Top Right and Bottom Right Latch/Lock Options



FD3D

3 HOUR FIRE-RATED ACCESS PANEL - DOUBLE DOOR

SELECT LATCH AND LOCKS BELOW OR ON PAGE 2 :

ONE CENTRAL POINT HANDLE - FOUR LATCHES

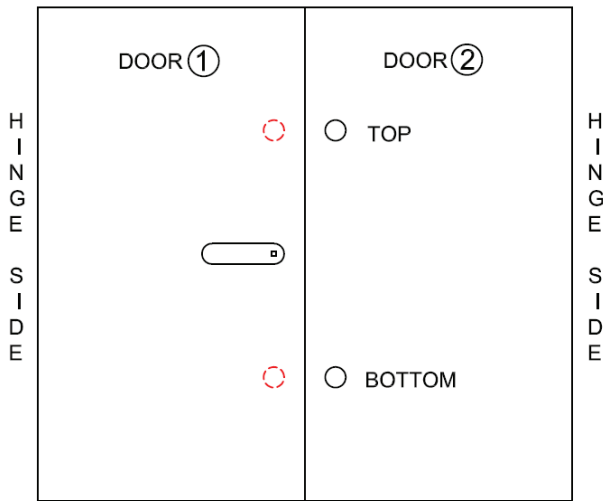

TWO CENTRAL POINT HANDLES - FOUR LATCHES

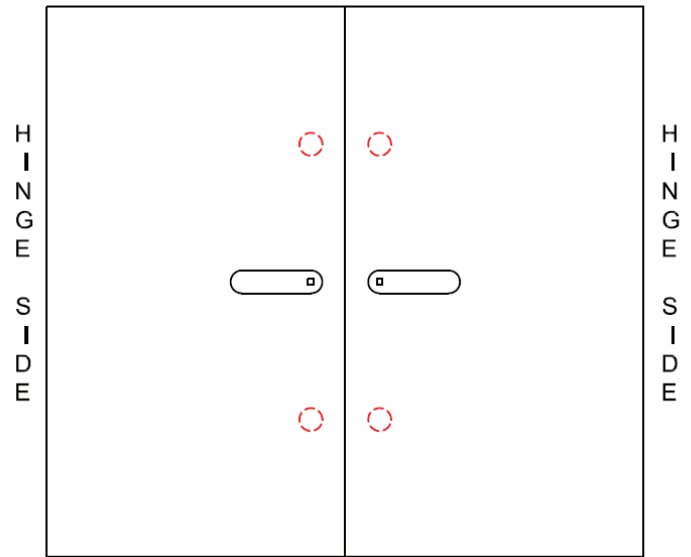

DOOR 1: Central Point Handle Controls
Two Concealed Latches on Door (shown in Red)

DOOR 2: Latch and Lock Options:

* Lock Option at Additional Cost

Latch and Lock Option	Top Right
Raised Knurled Knob	<input type="checkbox"/>
1-1/8" Mortise Prep*	<input type="checkbox"/>
1-1/8" Mortise Prep with Cylinder*	<input type="checkbox"/>

Central Point Handle Controls on Both Doors
Two Concealed Latches on Each Door

Latch and Lock Option	Bottom Right
Raised Knurled Knob	<input type="checkbox"/>
1-1/8" Mortise Prep*	<input type="checkbox"/>
1-1/8" Mortise Prep with Cylinder*	<input type="checkbox"/>

ONE CENTRAL POINT HANDLE - FOUR LATCHES

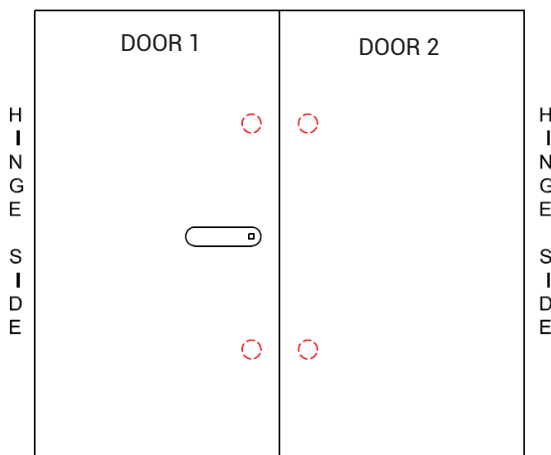

DOOR 1
Central Point Handle Controls Two Concealed Latches on Door.

DOOR 2
Two Concealed Latches on Door, Operable from the Inside Only.