



High-quality, architecturally pleasing, innovative access doors for walls, ceilings, ducts, floors and roofs



DUCT DOORS for Sheet Metal Duct

CD-5080

Application

- Assures a tight seal without obstruction in the air system

Product Features

- These doors are designed for use in LOW to medium pressure up to 3" static W.G.
- 5/8" notched knock over tabs on the inside of the frame provide for easy installation

Options:

- ALUMINUM
- STAINLESS STEEL
- VISION PANELS
- CYLINDER LOCK & KEY
- HASP + STAPLE
- L HANDLE

CD-5080 Duct Access Door Specifications:

Door: 24 gauge galvanized steel, double panel

Frame: 24 gauge galvanized steel with 5/8" notched knock over tabs

Insulation: Door panel filled with 2" fibreglass insulation (7.7 R factor), compressed into 1".

Gasketing: 1/8" thick by 1/2" wide closed cell neoprene gasketing between door and frame

Latch: Self tightening, hand operated cam latch



STANDARD SIZES (Special sizes available upon request)

NOMINAL DOOR SIZE W X H			WEIGHT PER DOOR	
inches	mm	Opening	lbs.	kg.
6 X 6	150 X 150	4-3/4 X 4-3/4	1.25	0.6
8 X 8	200 X 200	6-3/4 X 6-3/4	1.75	0.8
10 X 10	250 X 250	8-3/4 X 8-3/4	2.75	1.3
12 X 12	300 X 300	10-3/4 X 10-3/4	3.75	1.7
14 X 14	350 X 350	12-3/4 X 12-3/4	4.75	2.2
16 X 16	400 X 400	14-3/4 X 14-3/4	5.25	2.4
18 X 18	450 X 450	16-3/4 X 16-3/4	6.75	3.1
20 X 20	500 X 500	18-3/4 X 18-3/4	9	4.1
24 X 24	610 X 610	22-3/4 X 22-3/4	12	5.5

Duct opening is the NOMINAL DOOR SIZE - 1-1/4" (31mm)
For detailed specifications see submittal sheet

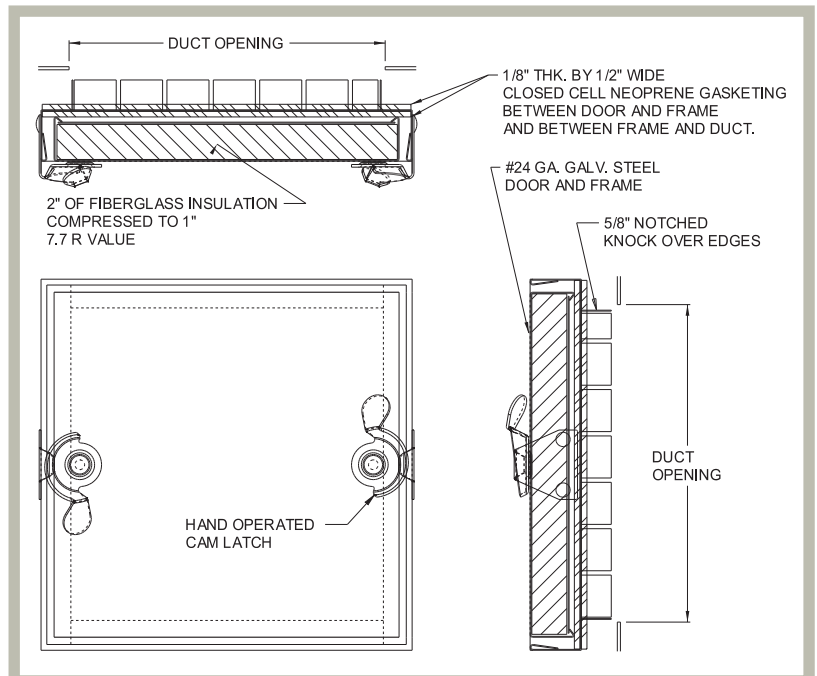

Click here to Online Product Page and Pricing

For more information, contact AccessDoorsAndPanels www.AccessDoorsAndPanels.com

Phone: 1-800-609-2917

Fax: 1-888-626-2907

Email: info@accessdoorsandpanels.com