

SUBMITTAL/TECHNICAL DATA SHEET



DESCRIPTION

Designed for ceiling applications, the Concealed Drop-In panel provides a seamless, aesthetically pleasing alternative to a traditional steel access door. Finish ready for paint or texture, this access door helps keep the attention where it belongs...on your space.

FEATURES

- Reduced Labor Costs
- Circular, Radius Corner or Square Corner
- Eco Friendly

SPECIFICATIONS

MODEL: BGFRC/BGFRR/BGFRS

DOOR: Gypsum Fiber Reinforced

FRAME: Gypsum Fiber Reinforced

SIZE:
Min: 6 inches by 6 inches
Max: 30 inches by 30 inches

INSTALLATION: Ceilings

FLANGE: Drywall Bead

FINISH: Unfinished Gypsum, Natural Gypsum White

WARRANTY: 1 year

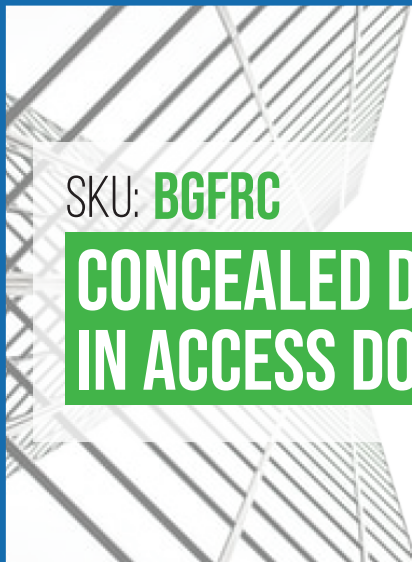

SKU: **BGFRC**

CONCEALED DROP IN ACCESS DOOR



DIMENSIONS AND APPEARANCE

>> CLICK TO VIEW ADDITIONAL DETAILS AND PRICING <<

ORDER GUIDE:

BASE	DOOR SHAPE	WIDTH	X	LENGTH
BGFR				
	C - Circular	STANDARD SIZES (W XL)		
	R - Radius Corner	8" x 8"		18" x 18"
		10" x 10"		22" x 30"
	S - Square Corner	12" x 12"		24" x 24"
		16" x 16"		30" x 30"

Rough opening is door size + 6 inches.

Additional sizes available, call for more information.

For Detailed Specifications See Submittal Sheet

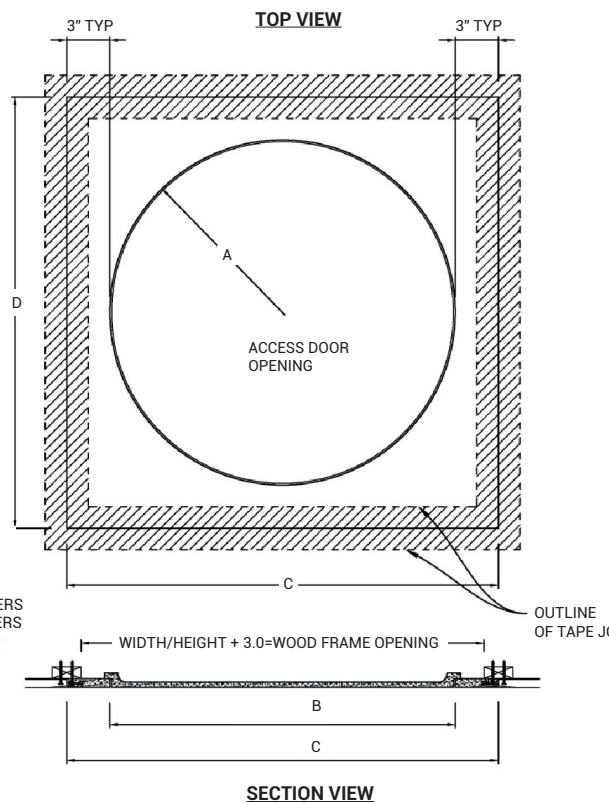
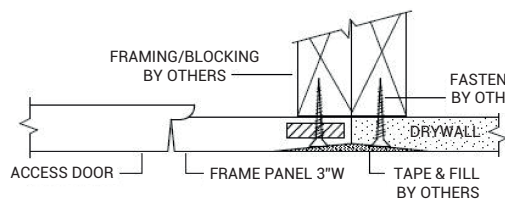

For a complete list of options visit www.AccessDoorsAndPanels.com

PROJECT DATA

Custom Sizes Available - Fast!

PROJECT NAME :	QTY	W	H	OPTIONS
ARCHITECT :				
DEALER :				
CONTRACTOR :				
LOCATION :	SPECIAL INSTRUCTIONS :			
DATE :	SUBMITTAL APPROVAL : (signature or stamp)			
TAGGING INSTRUCTIONS :				

Scan or Click



To view Pricing and Additional Product Info.

TELEPHONE:
1-888-457-1275
FAX:
1-888-626-2907



PO BOX 66738 #76520,
SAINT LOUIS, MO
63166-6738
USA



WEBSITE:
www.AccessDoorsAndPanels.com
E-MAIL:
info@AccessDoorsAndPanels.com



BGFRC

CONCEALED DROP IN ACCESS DOOR

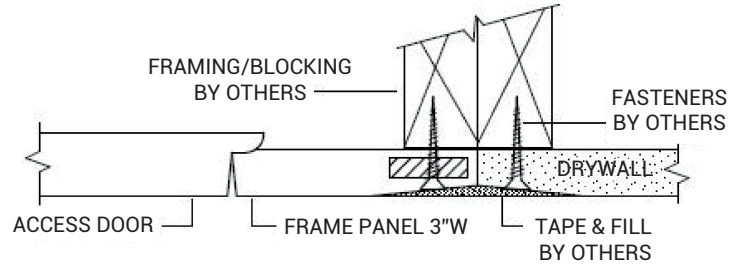
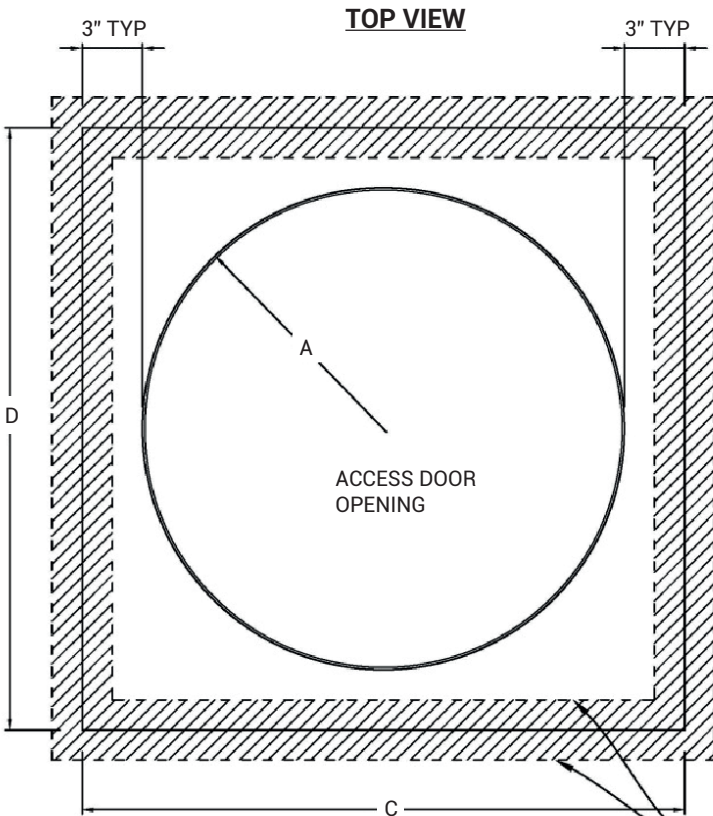

MATERIALS/TECHNICAL DATA:

- High Density Gypsum Cement Plaster, Natural White
- Post-Consumer Recycled Glass (70% by volume)
- Multi-layered Fiberglass Mat
- Plywood Embedment

OPTIONS:

- - 1/2" X 1/8" Neoprene Gasket

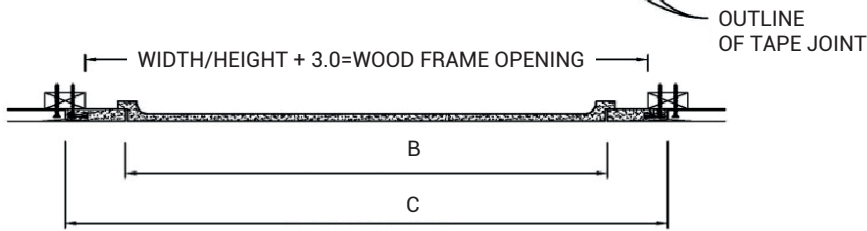

SECTION VIEW

QTY	PART #	DIM A (DOOR WIDTH)	DIM B (DOOR HEIGHT)	DIM C (DRYWALL OPENING WIDTH)	DIM D (DRYWALL OPENING HEIGHT)
	GFRR-0909	4.5"	9.0"	15.0"	15.0"
	GFRR-1212	6.0"	12.0"	18.0"	18.0"
	GFRR-1616	8.0"	16.0"	22.0"	22.0"
	GFRR-1818	9.0"	18.0"	24.0"	24.0"
	GFRR-2424	12.0"	18.0"	30.0"	30.0"