

DESCRIPTION

The H20 load rated large equipment hatch is designed for infrequent, off-street traffic where moisture or liquid flow into the door is a concern. The frame is constructed with a gutter channel for water runoff into a drainage system.

FEATURES

- H20 or HS20 Load.
- Diamond Tread Plate.
- Exterior Use.
- Drainable Frame with Gutter.
- Cast-In Installation.

SPECIFICATIONS

LOAD:

- BFDOH: H20
- BFDOH: HS20

DOOR: Double Door

MATERIAL: Aluminum - 1/4 inch, mill finish with gray primer on exterior frame.

COVER: Diamond tread plate.

FRAME: Drainable gutter frame with integral 1 inch anchor flange, EDPM gasket and 1-1/2 inch drain coupling.

INSTALLATION: Cast-In.

SPRING: Enclosed coil, Type 17-7 Stainless Steel

HINGE: Heavy-duty Type 316 Stainless Steel.

HOLD OPEN ARM: Type 316 Stainless Steel automatic hold open arm locks cover in open position.

LATCH: Slam latch Type 316 Stainless Steel with inside lever handle, includes removable threaded plug and key.

OPTIONS: Padlock Hasps, Finishes, Safety Grates, Safety Nets, Safety Rails, Skirting.

WARRANTY: 5 year

For a complete list of options visit
www.AccessDoorsAndPanels.com

SKU: **BFDOHA**

H20 DRAINABLE LARGE EQUIPMENT HATCH



DIMENSIONS AND APPEARANCE

>> CLICK TO VIEW ADDITIONAL DETAILS AND PRICING <<

ORDER GUIDE:

MODEL	LOAD	WIDTH	X	LENGTH	MATERIAL	
BFDO						DFL
	H - H20 S - HS20	DOUBLE DOOR 48" X 80" - 48" X 120" 60" X 80" - 60" X 120" 96" X 80" - 96" X 120" 108" X 48" - 108" X 120"			A - ALUMINUM	

Additional sizes and options available, call for more information.

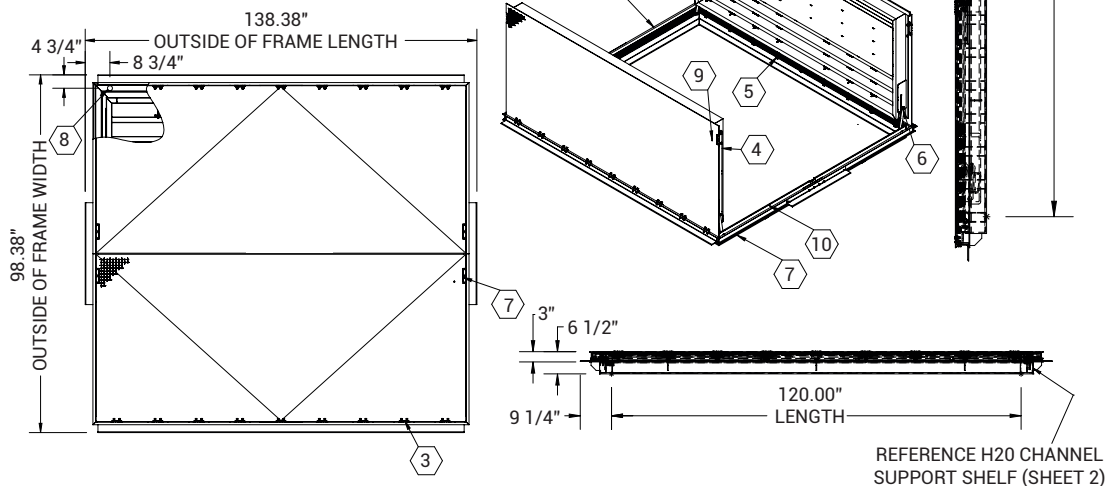

For Detailed Specifications See Submittal Sheet



PROJECT DATA

Custom Sizes Available - Fast!

PROJECT NAME :	QTY	W	H	OPTIONS
ARCHITECT :				
DEALER :				
CONTRACTOR :				
LOCATION :	SPECIAL INSTRUCTIONS :			
DATE :	SUBMITTAL APPROVAL : (signature or stamp)			
TAGGING INSTRUCTIONS :				

Scan  or  Click



To view Pricing and
Additional Product Info.



TELEPHONE:
1-888-457-1275
FAX:
1-888-626-2907



PO BOX 66738 #76520,
SAINT LOUIS, MO
63166-6738
USA



WEBSITE:
www.AccessDoorsAndPanels.com
E-MAIL:
info@AccessDoorsAndPanels.com



BFDOHA

H2O DRAINABLE LARGE EQUIPMENT HATCH

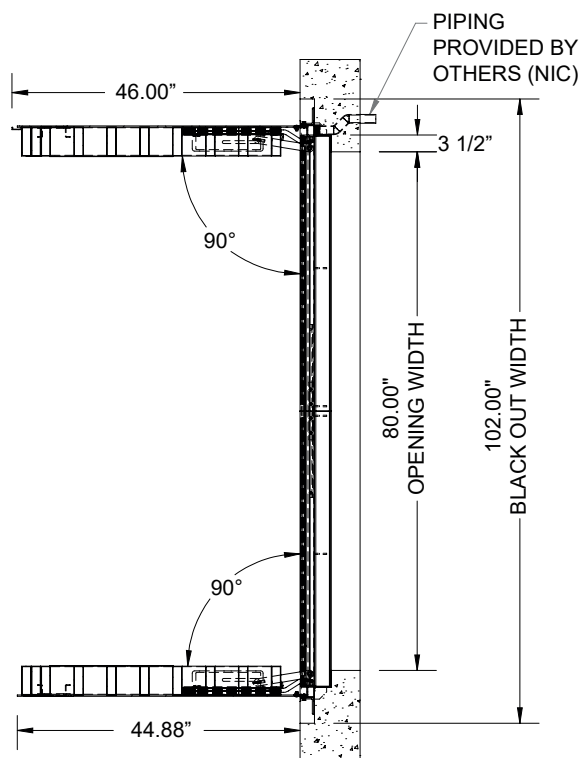
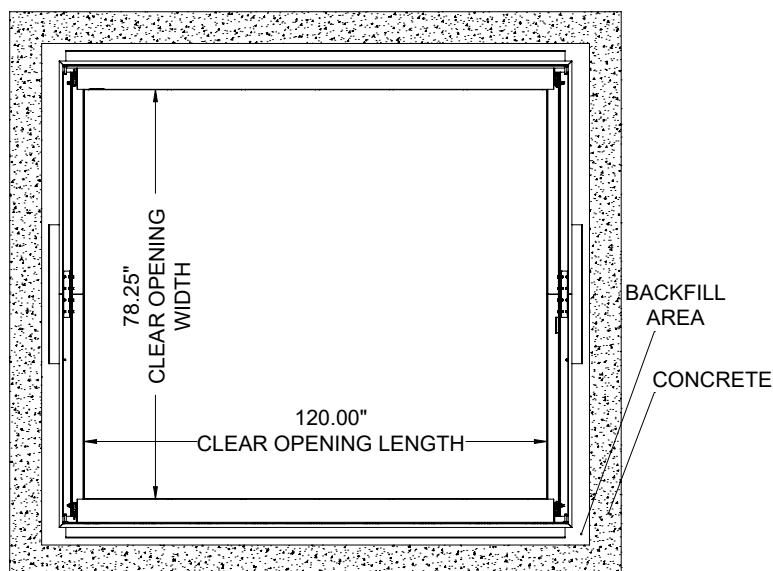

SPECIFICATIONS:

- ① **DOOR:** ALUMINUM, 1/4" DIAMOND PLATE, MILL FINISH WITH A H2O LOAD RATING FOR INFREQUENT LOW SPEED TRAFFIC WITH A MAXIMUM DEFLECTION OF L/150.
- ② **FRAME:** ALUMINUM, 1/4" EXTRUSION, GRAY PRIMER FINISH ON EXTERIOR SURFACES THAT COME IN CONTACT WITH CONCRETE.
- ③ **HINGES:** TYPE 316 STAINLESS STEEL.
- ④ **SLAM LATCH:** TYPE 316 STAINLESS STEEL WITH INSIDE LEVER HANDLE AND OUTSIDE REMOVABLE 5/16" SQUARE L HANDLE.
- ⑤ **COUNTER-BALANCE SPRING:** ENCLOSED 17-7 STAINLESS STEEL SPRING.
- ⑥ **HOLD-OPEN ARM:** TYPE 316 STAINLESS STEEL.
- ⑦ **FLUSH LIFTING HANDLE:** TYPE 316 STAINLESS STEEL.
- ⑧ **DRAINAGE COUPLING:** 1-1/2", FOR CONNECTION TO RUN OFF.
- ⑨ **FLUSH TYPE PLUG SEAL:** TYPE 316 STAINLESS STEEL
- ⑩ **GASKET:** EPDM

FLOOR DOOR SIZE:
80" (WIDTH) x 120" (LENGTH)

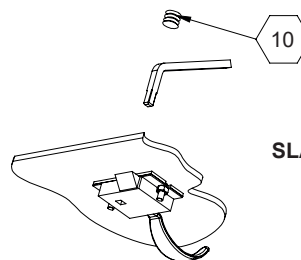

SLAM LATCH DETAIL

