



Quality Access Doors - FAST!

SUBMITTAL/TECHNICAL DATA SHEET

www.AccessDoorsAndPanels.com

SKU: **BA-ALI**

LIGHTWEIGHT INSULATED ALUMINUM ACCESS DOOR

FOR ALL SURFACE TYPES



STANDARD OPTIONS

- MATERIAL:**
0.064" aluminum
- HINGE:**
Aluminum continuous piano type
- GASKETING:**
Neoprene all around perimeter
- LOCK / LATCH:**
Cylinder lock and key
- FINISH:**
High quality white powder coat primer
- PACKAGING:**
Individually wrapped, 1 per box
- INSULATION:**
1" fiberglass

OPTIONS AVAILABLE

- LOCK / LATCH:**
 - Screwdriver operated cylinder cam latch
 - Mortise slam latch preparation (cylinder optional)
 - Handle operated cam latch
- MATERIAL:**
Stainless steel 304 #4 (brushed finish)

INSTALLATION

>> [CLICK TO VIEW ADDITIONAL DETAILS AND PRICING <<](#)

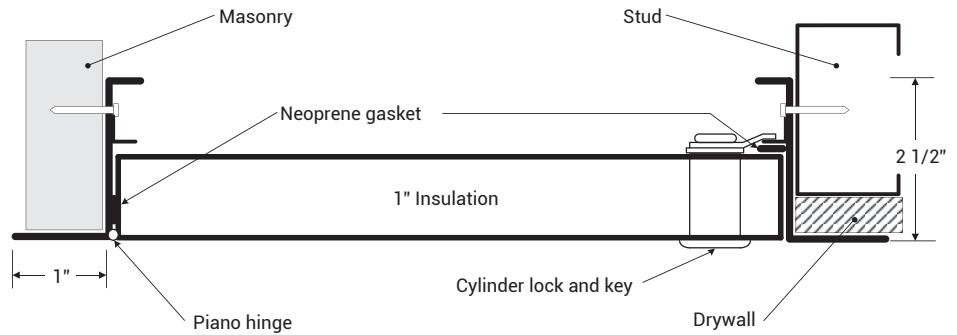

DIMENSIONS AND APPEARANCE

DOOR SIZE W x H INCHES (MM)	NUMBER OF LOCKS	WEIGHT	
		LBS	KG
8 x 8 (203 x 203)	1	2	0.9
12 x 12 (304 x 304)	1	3	1.4
16 x 16 (406 x 406)	1	6	2.7
18 x 18 (457 x 457)	1	7	3.2
24 x 24 (609 x 609)	1	13	5.9
36 x 36 (914 x 914)	2	21	9.5

ROUGH WALL OPENING IS DOOR SIZE + 1/4" OR + 6MM

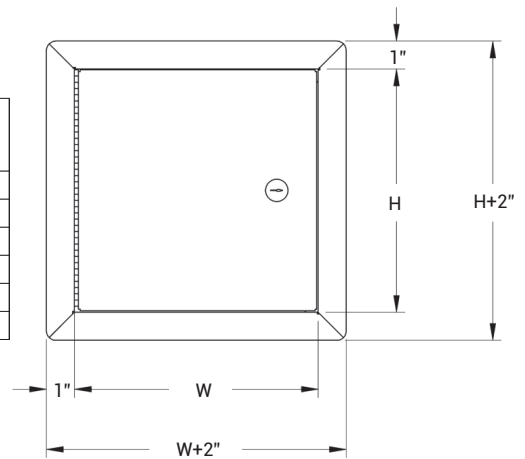

Scan or Click



To view Pricing and Additional Product Info.

LEED READY: THIS PRODUCT CONTRIBUTES TO LEED® CREDITS



PROJECT DATA

Custom Sizes Available - Fast!

PROJECT NAME :	QTY	W	H	OPTIONS
ARCHITECT :				
DEALER :				
CONTRACTOR :				
LOCATION :	SPECIAL INSTRUCTIONS :			
DATE :	SUBMITTAL APPROVAL : (signature or stamp)			
TAGGING INSTRUCTIONS :				

TELEPHONE:
1-888-457-1275
FAX:
1-888-626-2907

PO BOX 66738 #76520,
SAINT LOUIS, MO
63166-6738
USA

WEBSITE:
www.AccessDoorsAndPanels.com
E-MAIL:
info@AccessDoorsAndPanels.com