

# SUBMITTAL/TECHNICAL DATA SHEET



## DESCRIPTION

The class-leading Howe Green 1050 Series Heavy-Duty Floor Access Covers are suitable for all use with thicker and hard-wearing floor finishes to enable permanent, safe access to services concealed underneath.

The 1050 Series is available in single, duct or multipart configurations for use in interior or exterior areas up to 6.5 tonne pneumatic tyre wheel load. Manufactured in the UK and fire rated to BS 476 – Part 22, all covers are made to your exact specification with no time or cost constraint.

## SPECIFICATION

**TYPICAL FLOOR FINISHES:** All types of hard floor finish – ceramic tiles, marble, terrazzo, concrete, resin, wood or parquet floors.

**PERFORMANCE:** Heavy-duty, suitable for up to 6.5 tonne pneumatic tyre wheel load.

**FIRE RATING:** The 1050 Series is tested and fire rated to BS 476 – Part 22 for 2 hours on integrity in the case of a fire. This specification is for the use of the cover in a dead load environment only. If any permanent loads are applied this will invalidate the fire rating.



SKU: **1050**

## HEAVY DUTY STAINLESS STEEL FLOOR ACCESS COVERS

FOR INTERNAL AND EXTERNAL FLOOR FINISHES



## DIMENSIONS AND APPEARANCE

>> CLICK TO VIEW ADDITIONAL DETAILS AND PRICING <<

### MAXIMUM / MINIMUM SIZES

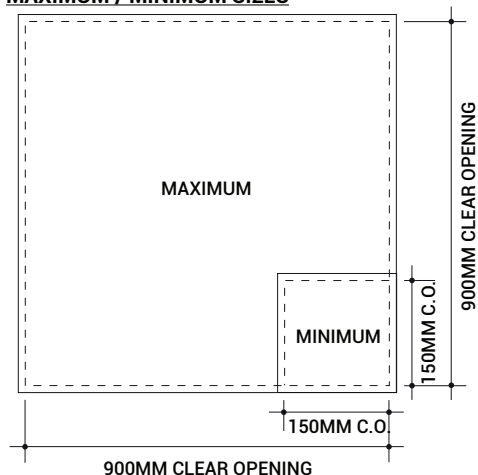

### TYPICAL FLOOR FINISHES:

External grade paving slabs including granite and concrete

### PERFORMANCE:

Up to 6.5 tonne pneumatic tyre wheel load (C250).

### OPTIONS:

Double seal. Inset lifting points.

### TYPICAL SPECIFICATION CLAUSE FOR 1050 SERIES:

Recessed floor access/ duct/ multipart\* covers and frames shall be Howe Green Ltd 1050 series, stainless steel with stainless steel/steel\* base plate and reinforcement, double sealed with socket head securing bolts/ unsealed with blanking bolts\*.

Sizes shall be as shown on contract drawings nos ....† Covers to be supplied complete with ....† sets of combined lifting/ securing keys. All to be manufactured and supplied by Howe Green Ltd, Marsh Lane, Ware, Hertfordshire, SG12 9QQ, Great Britain, and installed in accordance with the manufacturer's installation details and sitework guide.

\* Delete as appropriate. † Insert appropriate numbers & quantities

### SIZE:

Overall frame size = clear opening + 130mm e.g.  
600 x 900mm clear opening = 730 x 1030 mm overall frame.  
Subject to correct infill/installation (see separate guide).

### WEIGHT:

A 1050 series cover when filled with concrete weighs approx. 220 kg/m<sup>2</sup>.  
See also general notes on cover.

See Submittal page for more detailed information

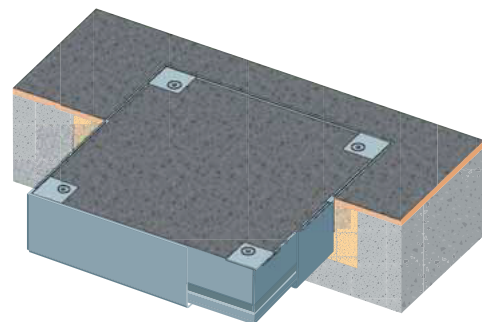

For a complete list of options visit [www.AccessDoorsAndPanels.com](http://www.AccessDoorsAndPanels.com)

## PROJECT DATA

Custom Sizes Available - Fast!

Scan or Click



To view Pricing and Additional Product Info.

PROJECT NAME :	QTY	W	H	OPTIONS
ARCHITECT :				
DEALER :				
CONTRACTOR :				
LOCATION :	SPECIAL INSTRUCTIONS :			
DATE :	SUBMITTAL APPROVAL : (signature or stamp)			
TAGGING INSTRUCTIONS :				

TELEPHONE:  
1-888-457-1275  
FAX:  
1-888-626-2907



PO BOX 66738 #76520,  
SAINT LOUIS, MO  
63166-6738  
USA



WEBSITE:  
[www.AccessDoorsAndPanels.com](http://www.AccessDoorsAndPanels.com)  
E-MAIL:  
[info@accessdoorsandpanels.com](mailto:info@accessdoorsandpanels.com)



**1050**

# HEAVY DUTY STAINLESS STEEL FLOOR ACCESS COVERS

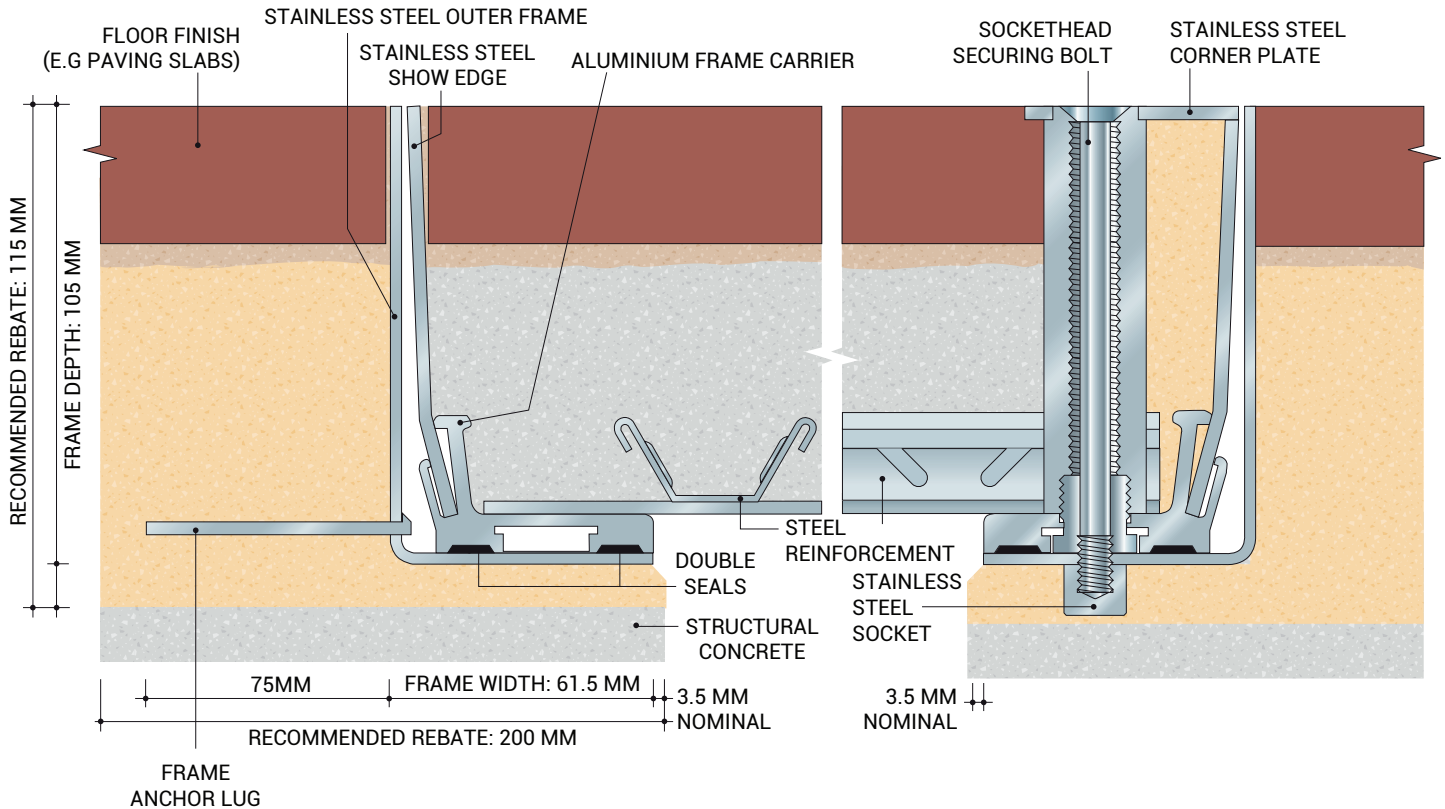

**FEATURES:**

- Specifically designed for use in external pedestrianised areas where vehicular access is required.
- Covers can be fitted quickly and unobtrusively into all types of hard floor finish: concrete or natural stone.
- Unique cover sections are tapered for easy removal, and frame sections give good key to bedding mortar. Covers are precision-made to avoid distortion.
- Double seals are available.
- Lifting blocks are anchored to the inner frame. Stainless steel securing bolts are stiletto heel proof.
- Quality control to BS EN ISO 9001.

**GENERAL NOTES ON 1050 SERIES FLOOR ACCESS COVERS:**

**Size** - All covers are made to measure. This allows the manufacture of any size between the stated maximum and minimum dimensions. Sizes that may be thought 'non-standard' can therefore be obtained without delay and without cost surcharge. The versatile nature of the Howe Green system allows any configuration of ducts and branches to be created.

**Weight** - The weight of the access cover should be taken into account where ease of handling is an important consideration. In all cases reference should be made to the Manual Handling Operations Regulations 1992, which implement European Directive 90/269/EEC. If loads are excessive, consideration should be given to the use of hydraulic lifters.